



CABINS IN THE Luleå archipelago



Luleå

Discover
the islands



Sauna bathing • Sightseeing • Tour boats
Cabin hosts • Winter accommodation

Brändöskär • Junkön
Kluntarna • Småskär



Rent a cabin in the Luleå archipelago!

A place that will stay in your heart.
Hundreds of charming islands and
seasons with magical contrasts.

SUMMER is full of warm days with swimming and sunbathing, hiking and midnight light. The tour boats go out to the islands daily from midsummer until mid-August.

AUTUMN invites you to pick mushrooms and berries and to wrap up your day by a warming campfire in the autumn dark.

WINTER and early spring offer activities such as fatbiking, snowmobiling and skiing across miles and miles of sea ice, as well as ice fishing at quiet nights under the northern lights.

SPRING brings the flora and fauna back to life with the sunshine.

Are you ready for a wonderful adventure?
Rent your cabin at www.lulea.se/skargard



The 4 bed cabin Orren, Småskär Island.



The 4 bed cabin Laxen, Brändöskär Island.

Genuine island environment

STAY IN ONE of the twelve cabins spread out across the four islands, Brändöskär, Junkön, Kluntarna and Småskär. All islands offer an authentic archipelagic experience – a barren environment with shingle fields, bare rock and long sandy beaches, contrasting with wild, old-growth forest. Here you will find traces of the land uplift following the ice age, lava tracks, old fishing villages and several unique species of plants and animals. Choose between a 4, 6 or 10 bed cabin, high up on the rocks, at the inner point of the bay, with or without pets, close to the sauna, or with amenities such as a toilet and shower.

Relaxing sauna

Enjoy a relaxing, wood-fired sauna after a day of adventures. Six of the islands in the Luleå archipelago have saunas available for booking; Antnäs-Börstskär, Brändöskär, Hindersön, Junkön, Kluntarna and Småskär Island.



Sauna at Kråkskärsviken, Kluntarna.

- All visitors may book a sauna free of charge.
- The sauna facilities can only be booked on location.
- Saunas are booked in person, next to the guest pier, max 1 hour/group.
- Clean the sauna and restock with new firewood after use.
- Important during winter: Empty the hot water container above the sauna heater inside the sauna.

Brändöskär Island



Four 4 bed cabins
One 6 bed cabin

THE FIVE rental cabins on Brändöskär are located near the fishing village, with their own patios and a view of the sea. All cabins are located in the same bay as the tour boat harbour. The cabins have solar cells that provide power for some lighting and 12V wall sockets for charging electronic devices. There is also essential cookware and near the cabins you will find a dry toilet, campfire sites, a firewood storage shed and a water well. During the high season, rowboats are available for cabin guests to borrow. Further into the bay, there are two wood-fired sauna, for everyone to book.



The 6 bed cabin, Löjan has an entrance hall/kitchen equipped with an LP gas stove and a refrigerator as well as two separate rooms. The smaller room has a bunk bed (90 cm wide) and the larger room has four single beds (90 cm wide). Both rooms have dining tables, chairs and wood burning stoves. Pets are only allowed in the Löjan cabin.



The 4 bed cabins Strömmingen, Öringen, Laxen and Harren all have an entrance hall/kitchen equipped with an LP gas stove and a refrigerator as well as a common room with a dining table, chairs, a wood burning stove and two bunk beds (90 and 105 cm wide). Pets are not allowed in these cabins.

(Building plans not to scale)

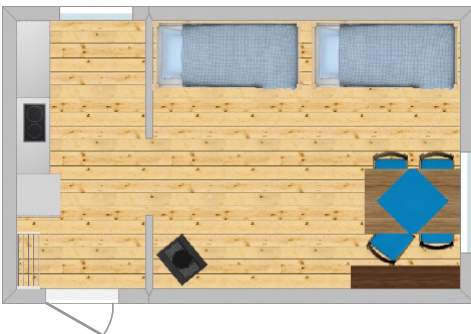



Erik Marklund's statue of Christ.



The fishing village, Brändöskär Island.



Environment that inspires

BRÄNDÖSKÄR is a very beautiful island in the outer rim of the archipelago. It's location, particularly exposed to weather and winds, has shaped the barren landscape that is often considered authentically archipelagic. For many, Brändöskär is also an artists' island. On arrival, visitors are greeted by Erik Marklund's statue of Christ, built on Hällgrundet in 1957. The same artist is also the creator of the altarpiece in the Brändöskär chapel, built in 1774. Since 2005, the east side of the island has been home to sculptures by artist Ola Taube.

BRÄNDÖSKÄR and Uddskär form a sheltered bay that is home to a guest harbour and the fishing village. In the early history of this fishing village the islands were separate and the Uddskär side likely hosted the main part of the fishing village. The outer part of Brändöskär is hilly and consists of rounded cliffs. Here you will find the unique rock type Haparanda monzonite and you can also see how the inland ice has polished the rock and created ridges in it. On the more forested Uddskär side, there are excellent opportunities for hiking,

● The trails on Brändöskär are small and rocky.

Junkön Island



Two 4 bed cabins with WC/shower

THE TWO rental cabins on Junkön are found in a scenic location next to each other, adjacent to a grassy, sandy meadow, with their own patios and a view of the sea, just a stone's throw from the guest harbour and the sauna. The cabins can easily be reached from the guest and tour boat harbours via footbridges.

The 4 bed cabins Örn and Falken both have an entrance hall, a bathroom with a toilet and shower and a combined common room/kitchen equipped with a stove, microwave oven, refrigerator, dining table, chairs, a wood burning stove as well as two 90 cm wide bunk beds. You may only bring pets to the Falken cabin.

THE JUNKÖN cabins offer more amenities than the other cabins in the archipelago as they are equipped with electricity, running water and essential cookware.

On Junkön, there are two wood-fired saunas, available for all island visitors to book.



Kitchen and dining table with four chairs.

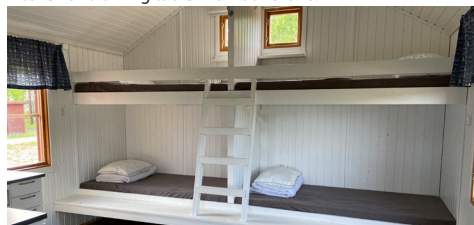

Two bunk beds.

The 4 bed cabins Örn and Falken at Junkön.

(Building plans not to scale)

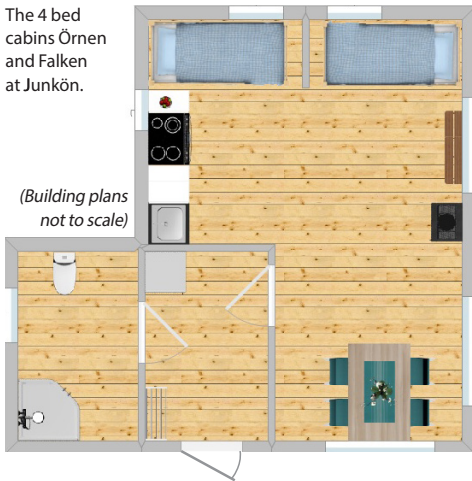



Little child close to the guest harbour.

Let history lead the way

JUNKÖN IS one of the larger islands in the archipelago with a number of permanent residents and it is also the home port of many professional fishermen. Junkön was first mentioned in writing in 1491 and at that time the island had barely surfaced from the sea. At the guest harbour you will find an archipelago museum, a boat engine museum and a summer café. Adjacent to the guest harbour you will also find toilets, showers, drinking water and grill spots. Take a moment to walk around the island, the centre of the village offers an authentic, alluring archipelagic environment with a gallery open during the summer months.

THERE ARE trails and small roads that lead amongst other places, to a nice sandy beach on the north-eastern tip of the island. Do not miss the mysterious windmill, more than 200 years old. The mill, a so called smock mill, was probably built in the late 18th century and it is not known with certainty how it came to Junkön.

PLEASE NOTE that almost half the island is a designated practice area for the F 21 Air Wing. Public access to the southern part of the island is prohibited.

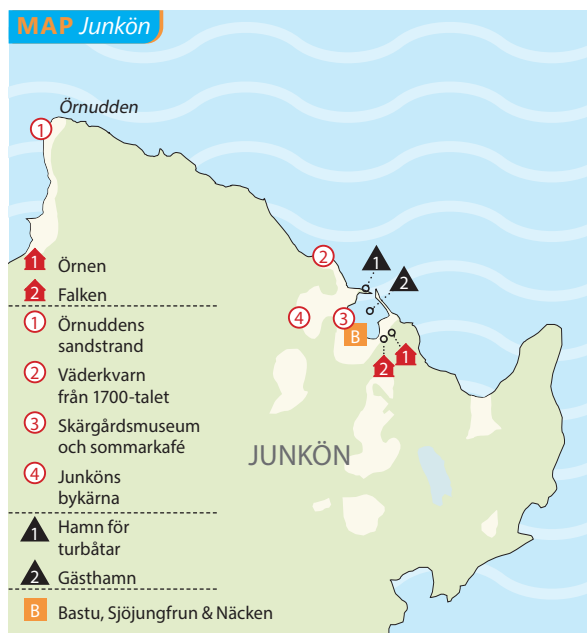



Two 4 bed cabins
One 10 bed cabin

Kluntarna Island

THE THREE rental cabins on Kluntarna are located between the edge of the forest and the beach, inside the sheltered Storviken bay with their own patio and a view of the sea. The cabins are easily accessible via footbridges from the guest and tour boat harbours.

The cabins have solar panels that provide electricity for some lighting as well as 12V sockets for charging electronic devices. There is also essential cookware available and near the cabins you will find a dry toilet, grilling sites, a firewood storage shed and a water well. During the high season, cabin guests can borrow rowing boats with life jackets from the cabin hosts.

THERE ARE TWO wood-fired saunas on Kluntarna, one at Storviken and one at Kråkskärviken, available for all visitors to book.



Truten has ten beds and offers a great sea view.



The 10 bed cabin, Truten is found in a secluded location in the innermost part of Storviken. The cabin has an entrance hall/kitchen, sleeping quarters with two bunk beds (160 cm wide) and a common room with three 80 cm bunk beds as well as a dining table and chairs. Pets are not allowed in the Truten cabin.

(Building plans not to scale)

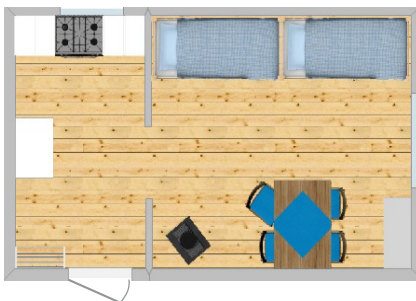

The four bed cabins Tärnan and Måsen are located side by side, next to the Storviken sauna. The cabins both have an entrance hall/kitchen equipped with an LP gas stove, refrigerator as well as a common room with a dining table, chairs, a wood burning stove and two bunk beds (90 cm wide). You may only bring pets to the Tärnan cabin.

Adventures await you

KLUNTARNA is a highly interesting island to visit if you wish to experience the authentic natural environment typical of the archipelago, most of the archipelagic flora and fauna is found here. Kluntarna has been seasonally populated for centuries and used as a base for fishing and seal hunting.

TAKE YOUR time and walk around the island to see all the sights. During your walk you can find remains of old building foundations and racks for drying fishing nets, labyrinths and other traces of human activities. The five labyrinths were likely built in the 14th or 15th century. For those who are not afraid of heights, the view from the observation tower is highly recommended.

LAST BUT not least, do not miss taking a look at the Kluntgubben (Swedish for the Kluntarna Man) rock formation.

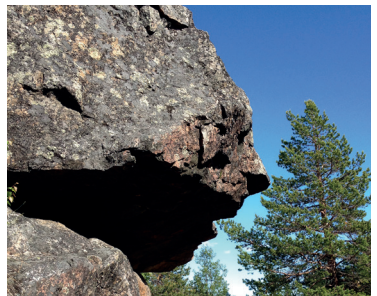

"Kluntgubben" – The Kluntarna Man.



Most of the archipelagic flora and fauna is found here.



Småskär Island



Two 4 bed cabins

THE TWO rental cabins on Småskär are located at the innermost point of the Bullerhamnsviken bay, with a beautiful view of the sea from their patios and lush forest behind them.

The cabins have solar panels that provide electricity for some lighting and 12V sockets for charging electronic devices.

THERE IS also essential cookware and near the cabins you will find a dry toilet, grilling sites and a firewood storage shed. You must bring enough drinking water to last your entire stay as there is no public well. A rowing boat and life jackets are available for cabin guests to borrow. There is one wood-fired sauna on Småskär, available for all visitors to book.



Tjädern and Orren, located just a few steps from each other.



Inside the cabin Orren.

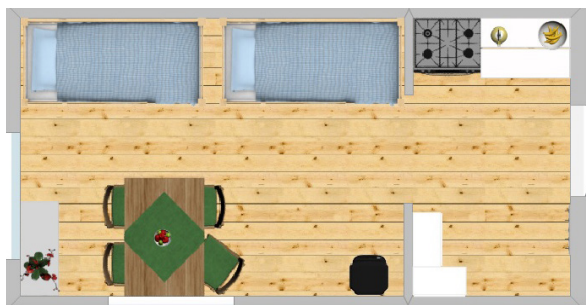

The four bed cabins, Tjädern and Orren are located side by side next to the sauna. The cabins both have an entrance hall/kitchen equipped with an LP gas stove and a refrigerator as well as a common room with a dining table, chairs, a wood burning stove and two bunk beds (90 cm wide). You may not bring pets to the cabins on Småskär.
(Building plans not to scale)



The Småskär chapel and the guest harbour.



A beautiful royal gift

SMÅSKÄR is a beautiful island in the outermost part of the archipelago – when walking around the island you will experience the diversity of the archipelago. Bays with fishing villages, boathouses and sandy beaches, old-growth forest, rocks and cliffs, shingle fields, magical little lakes and rich bird life with around 40 breeding species.

The oldest chapel in the archipelago was built in 1720 at Kyrkviken and is well worth a visit. The Kyrkviken fishing village was most likely established as early as the 16th century and remained in use well into the 20th century.

IN 1652 Queen Christina gifted Småskär to the burghers of Luleå and it was named Småskär (little islets) as it once consisted of many small islets, now grown together because of land uplift.

Småskär is the most popular island for holiday homes in the archipelago, there are about 90 holiday homes here, primarily at Bullerhamnsviken, Bolinsviken and the area surrounding Kyrkviken.

The waters east of Småskär, around Månshällan and Bjässhällan, are the best place to go to in Luleå archipelago to spot seals.

• The trails on Småskär are small and rocky.

A round trip out to sea



TOUR BOATS

From the beginning of June until mid-September, a scheduled tour boat will take you to and from the islands in the Luleå archipelago, with daily tours from midsummer until mid-August. The boat stops at the islands Klubbviken/Sandön, Junkön, Kluntarna, Småskär, Brändöskär and Hindersön if weather permits. The journey through the archipelago is part of the experience and aboard the boat you can enjoy food and beverages on the way to your island destination.



One of the tour boats operating the archipelago.



GUEST HARBOURS

For those travelling aboard their own boats, Luleå Council operates 11 great guest harbours. The guest harbour fee is paid daily on location or by buying a season pass in

advance. The season pass is valid at Antnäs-Börstskär, Altappen, Brändöskär, Degerö-Börstskär, Hindersön, Stensborg, Junkön, Kluntarna and Småskär.



During the high season harbour- and cabin hosts are at your service at Junkön, Kluntarna, Småskär och Brändöskär.



CHECK-IN
at 3PM



CHECK-OUT
at 12PM

Good to know

CABIN HOSTS AND KEYS

During high season, from midsummer until mid-August, cabin hosts are stationed out on the island. During this period you will leave your keys with the hosts. The keys at Brändöskär are always collected at/returned to the Luleå Tourist Center in Kulturens hus. During the low season, mid- August until mid-June, all keys are collected at /returned to the Luleå Tourist Center.

THINGS TO REMEMBER

Bring extra food (and drinking water to Småskär), warm clothes, bed linen or sleeping bags, towels, toilet paper, washing up liquid, candles, match-es, a flashlight, a power bank and a 12V USB adapter.

FACILITIES

The cabins have between four and ten beds, each with a mattress, duvet and pillow. The cabins are equipped with kitchen utilities, fire extinguishers, fire blankets, first aid kits and cleaning equipment. Firewood for the wood burning stove is found in a separate firewood storage shed.

ON DEPARTURE

The cabins must be cleaned by the guest before departure. If it is not cleaned, guests will be charged for the cost of cleaning. For more information, please read the cleaning guide found in the cabin.



Make sure that the cabin is nice and cleaned at your departure.



The archipelago in winter

THERE IS a lot to discover in the archipelago during the winter. You can enjoy miles and miles of vast, white landscapes – an arctic environment a stone's throw away from the city of Luleå. The easiest way to reach the archipelago is via the snowmobile trails which are maintained by Luleå Council.

WHEN THE ICE in the archipelago has reached a sufficient thickness, several miles of roads are prepared, going out to a couple of the islands. Once they have been finished, you can travel part of the way by car and then switch to cross-country skis or fatbike for the last leg of the journey to a cabin in the archipelago.



Winter facts

ICE THICKNESS and weather conditions are crucial in winter. Be informed and well prepared before you travel out into the archipelago. The archipelagic climate is similar to the unpredictable weather conditions often found in the mountain world. Take no risks!

IMPORTANT ON ARRIVAL

- Make sure to arrive in good time, to have time to clear snow and warm up the cabin.
- Turn on the gas.
- Turn on the refrigerator.

IMPORTANT ON DEPARTURE

- Close the window shutters.
- Turn off the refrigerator and leave it open.
- Turn off the gas inside the cabin.
- After using the sauna: Empty the hot water container.
- Bring your refuse back to the mainland.



ROUTE Summer & winter

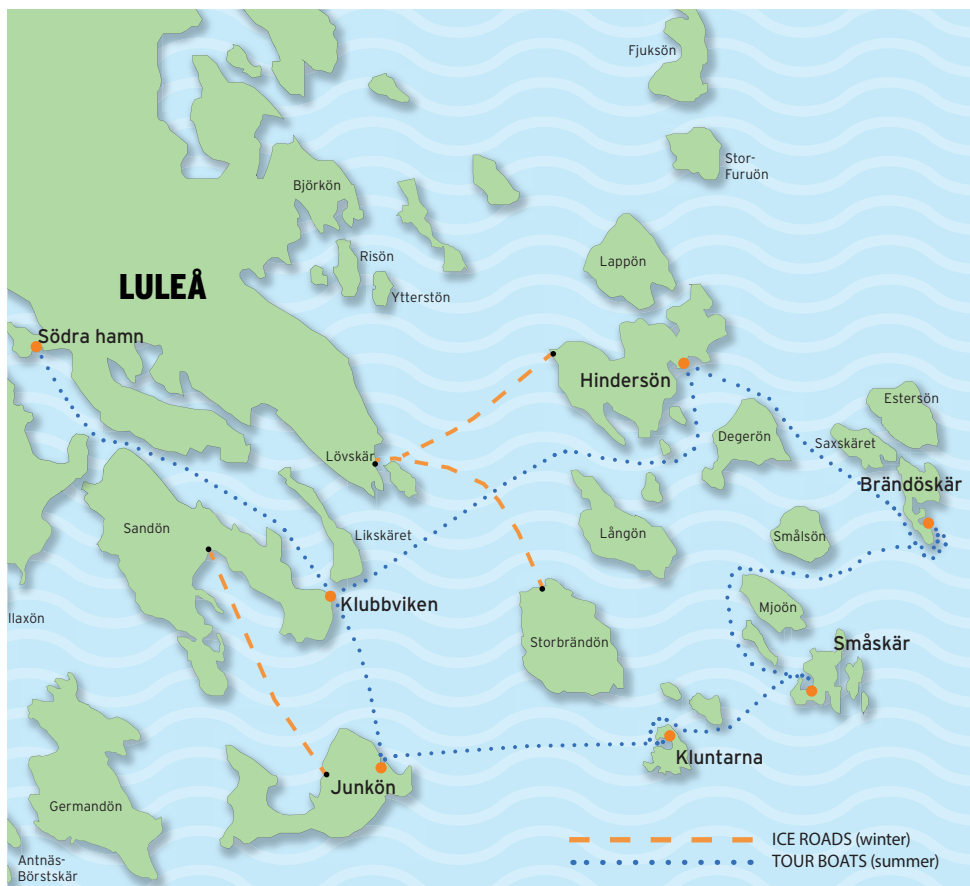

DISTANCES

Storbrändön – Kluntarna.....approx. 5 km
 Storbrändön – Småskär.....approx. 8 km
 Lövsjär – Hinderjönapprox. 8 km

Lövsjär – Storbrändönapprox. 8 km
 Sandön – Junkön.....approx. 9 km
 Hinderjön – Brändöskär.....approx. 10 km

Visit the archipelago!



Book your cabin at
www.lulea.se/skargard



LULEÅ KOMMUN